

NOTES:

All proposals are indicative only, not to scale and subject to detailed designs and consultation.

Towpath to be resurfaced with self-binding aggregate, to match that provided to the West of Kildwick. See photo.

Towpath to be widened to 2m where possible but there are sections where only 1.5m can be provided. See plan.

Widths to allow retention of verges to front and rear of towpath in keeping with rural character.

Vehicle controls to be bollards with reflective strips and spaced with 1.5m gaps.

Opportunities for benches and place-making to be identified.

Map is not to scale.



Existing muddy state of towpath



Existing towpath in Kildwick



Damage to canal wash walls to be repaired

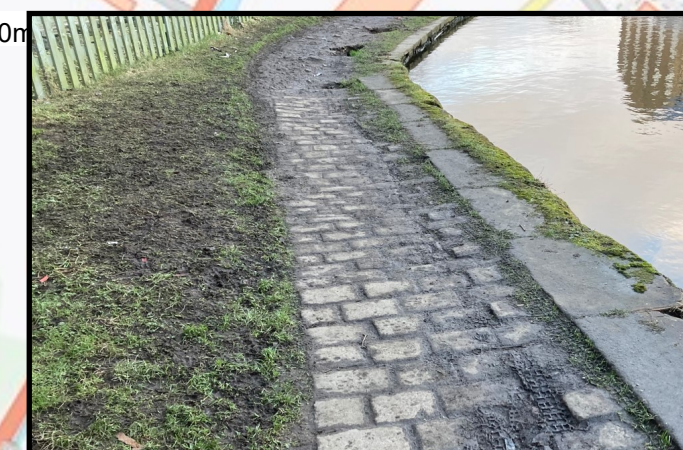
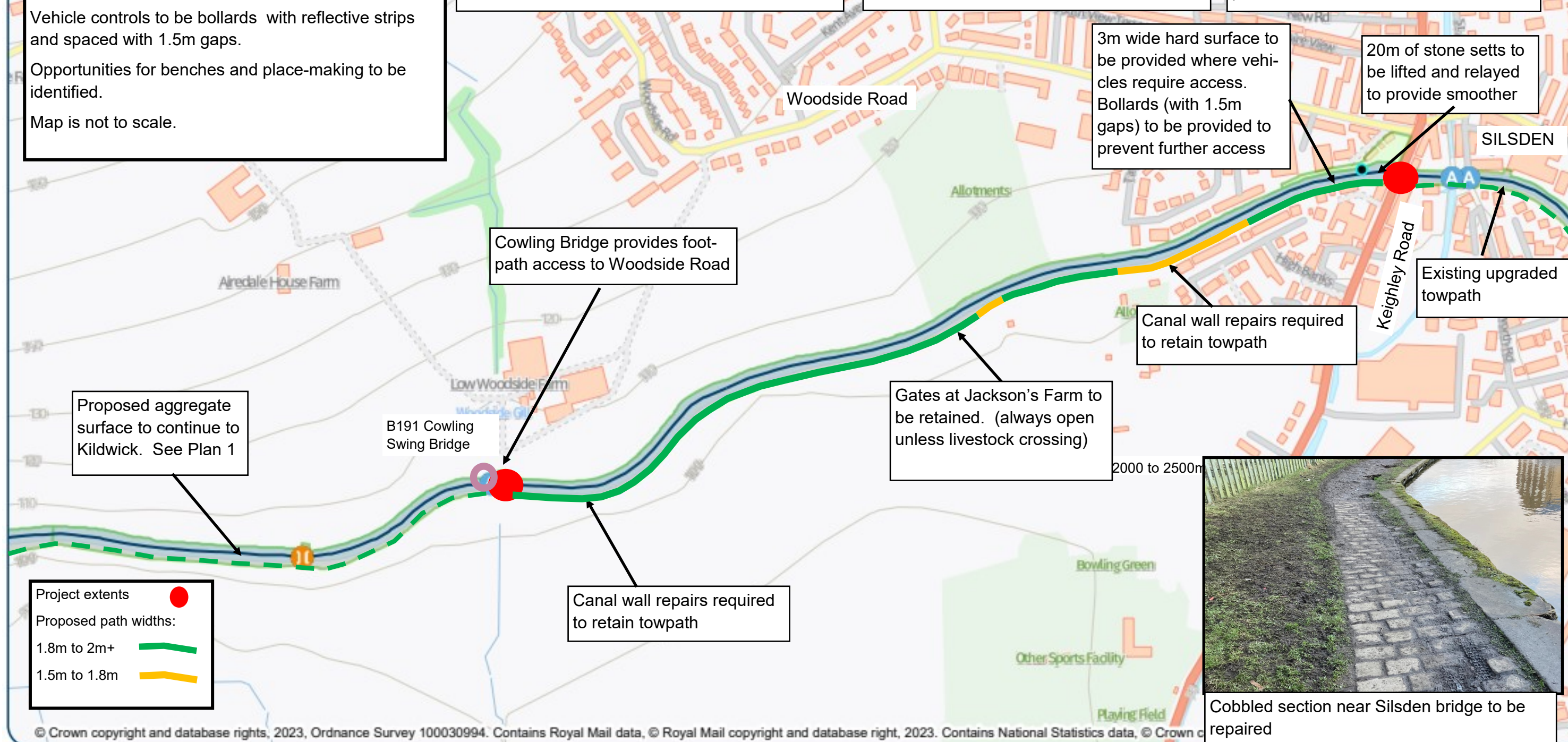

Cobbled section near Silsden bridge to be repaired