

- Legend**
- Hale Wharf Estate Boundary
  - Thames Water Ownership
  - Canal & River Trust Ownership
  - Proposed bridge
  - Lease area
  - Easement area

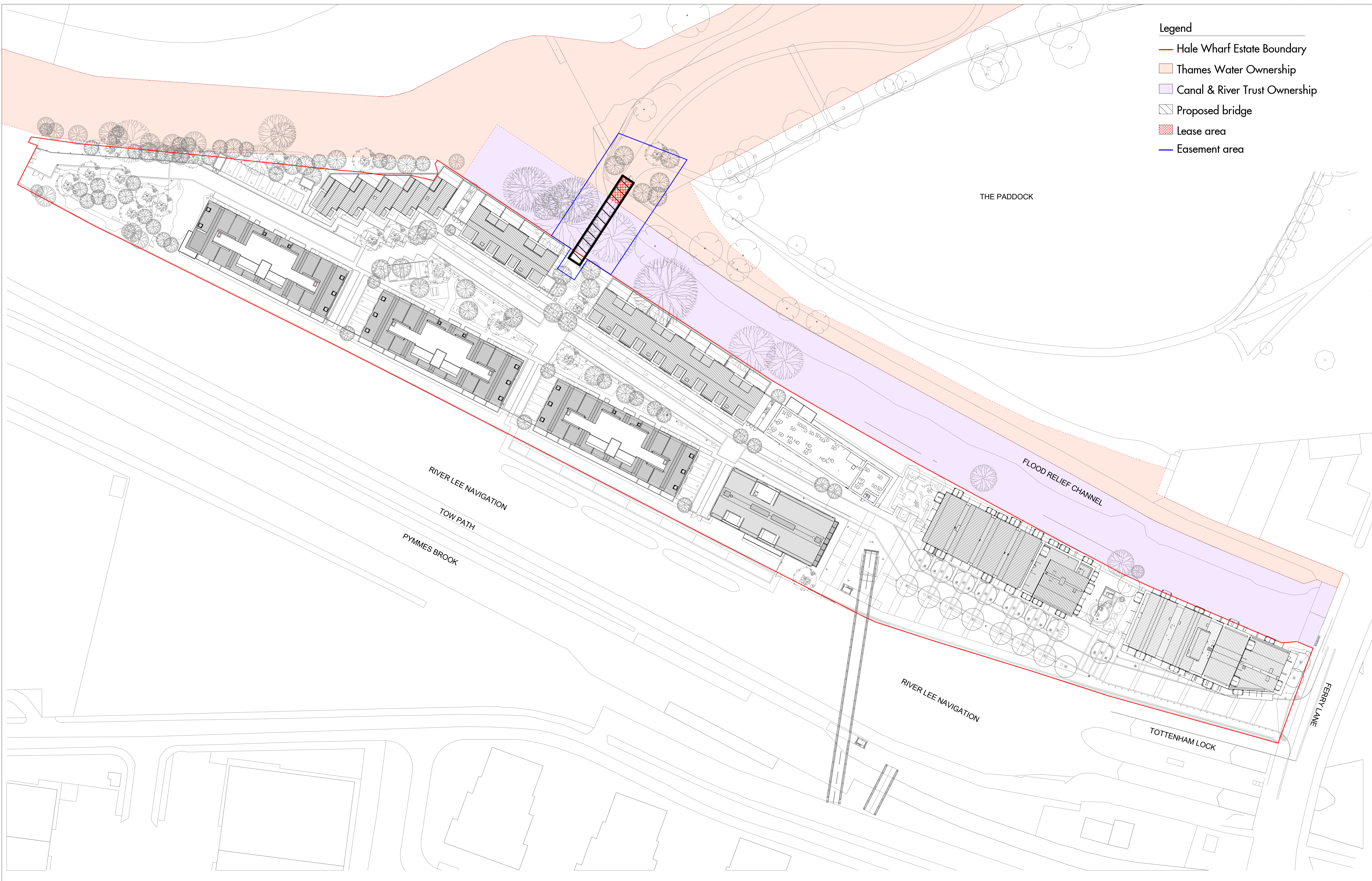

Do not scale from this drawing. Use figured dimensions only. Figured dimensions are in millimetres unless noted otherwise. All dimensions and levels shall be verified on site before proceeding with works. Detailed site survey to be carried out to verify positions and level relationships with site features and ordnance survey. The Architect must be notified of any discrepancy. Boundaries are indicative only and are to be verified by others. Where building components are described in the specification as Descriptive Specification (Contractor Design) elements shown on this drawing pertaining to those components are to be read as "Issued for Design Intent only".  
 Allies & Morrison LLP is not responsible for any errors caused by the transmission, translation, software or computer systems. Allies & Morrison LLP is not responsible for nor shall be liable for the consequences of any use made of the drawings or models other than that for which they were produced by Allies & Morrison LLP for the Client.  
 All Intellectual Property Rights reserved.

REV	DATE	DESCRIPTION	CKD
P1	29.11.21	Draft for Comment	SF
P2	07.12.21	ISSUED FOR INFORMATION	SF
P3	18.01.22	ISSUED FOR INFORMATION	SF
P4	18.02.22	ISSUED FOR INFORMATION	SF
P5	14.03.22	ISSUED FOR INFORMATION	SF
P6	16.03.22	ISSUED FOR INFORMATION	SF

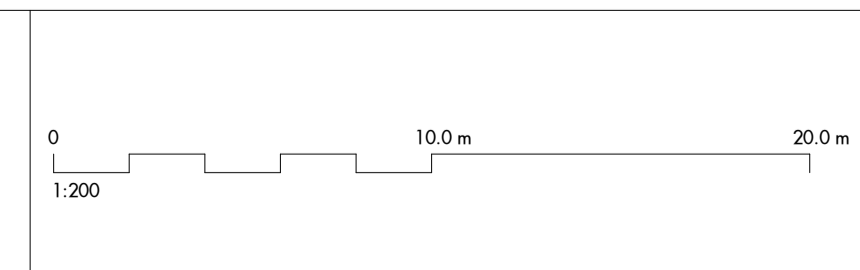

**Allies and Morrison LLP**  
 85 Southwark Street  
 London SE1 0HQ  
 telephone 020 7921 0100  
 facsimile 020 7921 0101  
 email studio@alliesandmorrison.com

Hale Wharf - Phase 2  
 Phase 2 Bridge  
 Lease Plan  
 535\_05\_04\_420  
 SCALE 1 : 500 @A1 1 : 1000 @A3